



WARREN COURT, EUSTON ROAD, LONDON NW1

£725 PW



PROPERTY REFERENCE CODE: RL0620

WARREN COURT, EUSTON ROAD, LONDON NW1

Fantastic two double bedroom apartment seconds away from Warren Street station located in the heart of Euston.

- A STUNNING 2 DOUBLE BEDROOM FLAT
- GREAT SIZE RECEPTION ROOM
- LIFT ACCESS
- LOCATED IN HEART OF EUSTON
- QUICK ACCESS TO WARREN ST STATION

This property benefits from a great size reception room, a fully fitted kitchen with modern appliances, and a lovely bathroom.

The property also included lift access.

There is an additional £35 per week gas charge on top of the rent.





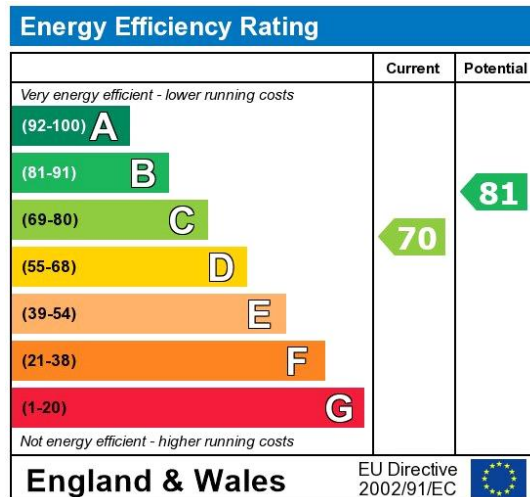

The energy efficiency rating is a measure of the overall efficiency of a home. The higher the rating the more energy efficient the home is and the lower the fuel bills will be.

Whilst every effort is made to ensure the accuracy of these details, it should be noted that the measurements are approximate only. Floorplans are for representation purposes only and prepared according to the RICS Code of Measuring Practice by our floorplan provider. Therefore, the layout of doors, windows and rooms are approximate and should be regarded as such by any prospective tenant.

Warren Court

Approx. Gross Internal Area 616 Sq Ft - 57.23 Sq M

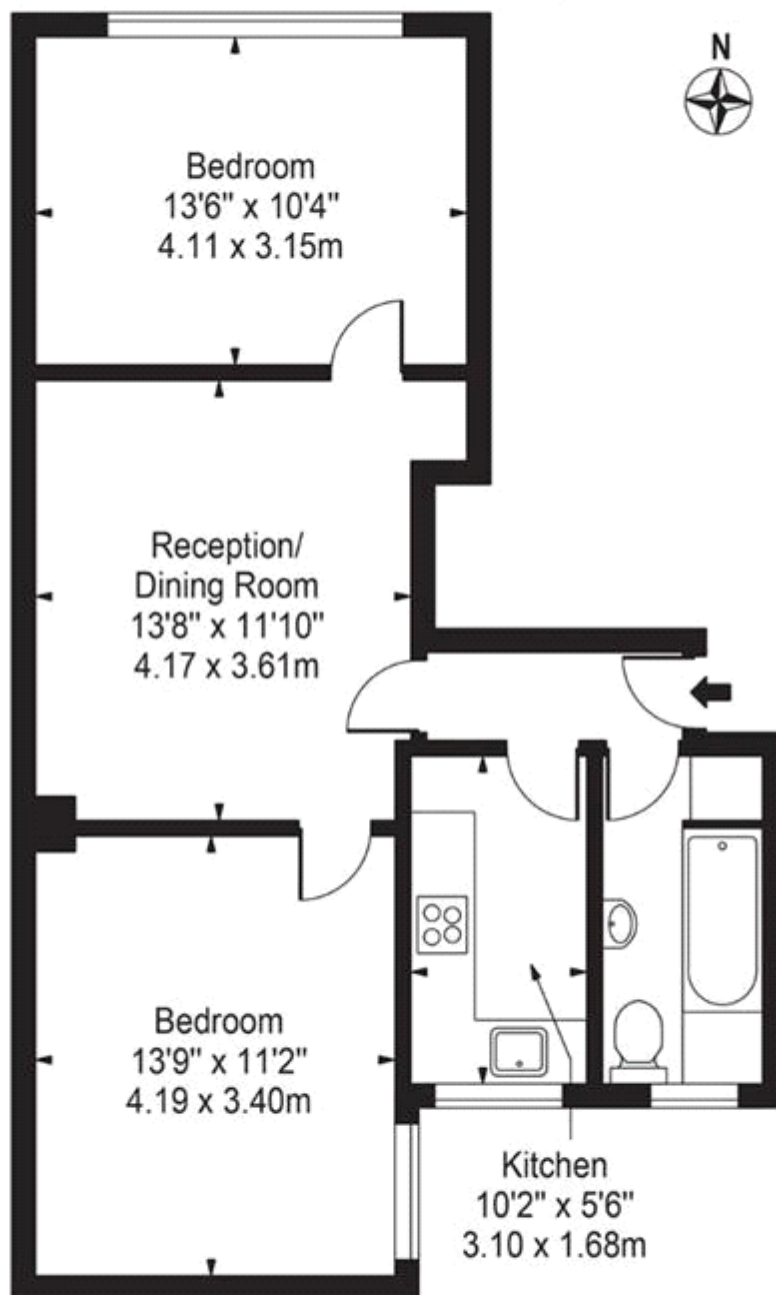

First Floor

For Illustration Purposes Only - Not To Scale

This floor plan should be used as a general outline for guidance only and does not constitute in whole or in part an offer or contract. Any intending purchaser or lessee should satisfy themselves by inspection, searches, enquiries and full survey as to the correctness of each statement. Any areas, measurements or distances quoted are approximate and should not be used to value a property or be the basis of any sale or let.

Viewing by appointment only
Maison Chase - Maison Chase
41A Mill Lane, West Hampstead, London NW6 1NB
Tel: 020 3951 7464
Email: home@maisonchase.co.uk
Website: www.maisonchase.co.uk

