



Maison Chase

CLIVE COURT, MAIDA VALE, LONDON

£1,265 PW



NEWLY RENOVATED THROUGHOUT 3 BEDROOM W9

PROPERTY REFERENCE CODE: RL1296

CLIVE COURT, MAIDA VALE, LONDON

Newly renovated 3 bedroom 2 bathroom flat, set within this beautiful mansion block with a 24-hour porter and communal gardens.

- A STUNNING THREE BEDROOM APARTMENT
- TWO BATHROOMS
- BRIGHT AND AIRY RECEPTION ROOM
- INTEGRATED KITCHEN DESIGN
- 24-HOUR PORTER SERVICE
- COMMUNAL GARDENS
- AMAZING LOCAL AMENITIES

The property is in splendid condition throughout and consists of an entrance hall, large & bright reception room, modern integrated kitchen, three double bedrooms, a good storage space and two beautiful bathrooms.

Council Tax Band: F







Energy Efficiency Rating		
	Current	Potential
<i>Very energy efficient - lower running costs</i>		
(92-100) A		
(81-91) B		85
(69-80) C	79	
(55-68) D		
(39-54) E		
(21-38) F		
(1-20) G		
<i>Not energy efficient - higher running costs</i>		
England & Wales	EU Directive 2002/91/EC	

The energy efficiency rating is a measure of the overall efficiency of a home. The higher the rating the more energy efficient the home is and the lower the fuel bills will be.

Whilst every effort is made to ensure the accuracy of these details, it should be noted that the measurements are approximate only. Floorplans are for representation purposes only and prepared according to the RICS Code of Measuring Practice by our floorplan provider. Therefore, the layout of doors, windows and rooms are approximate and should be regarded as such by any prospective tenant.

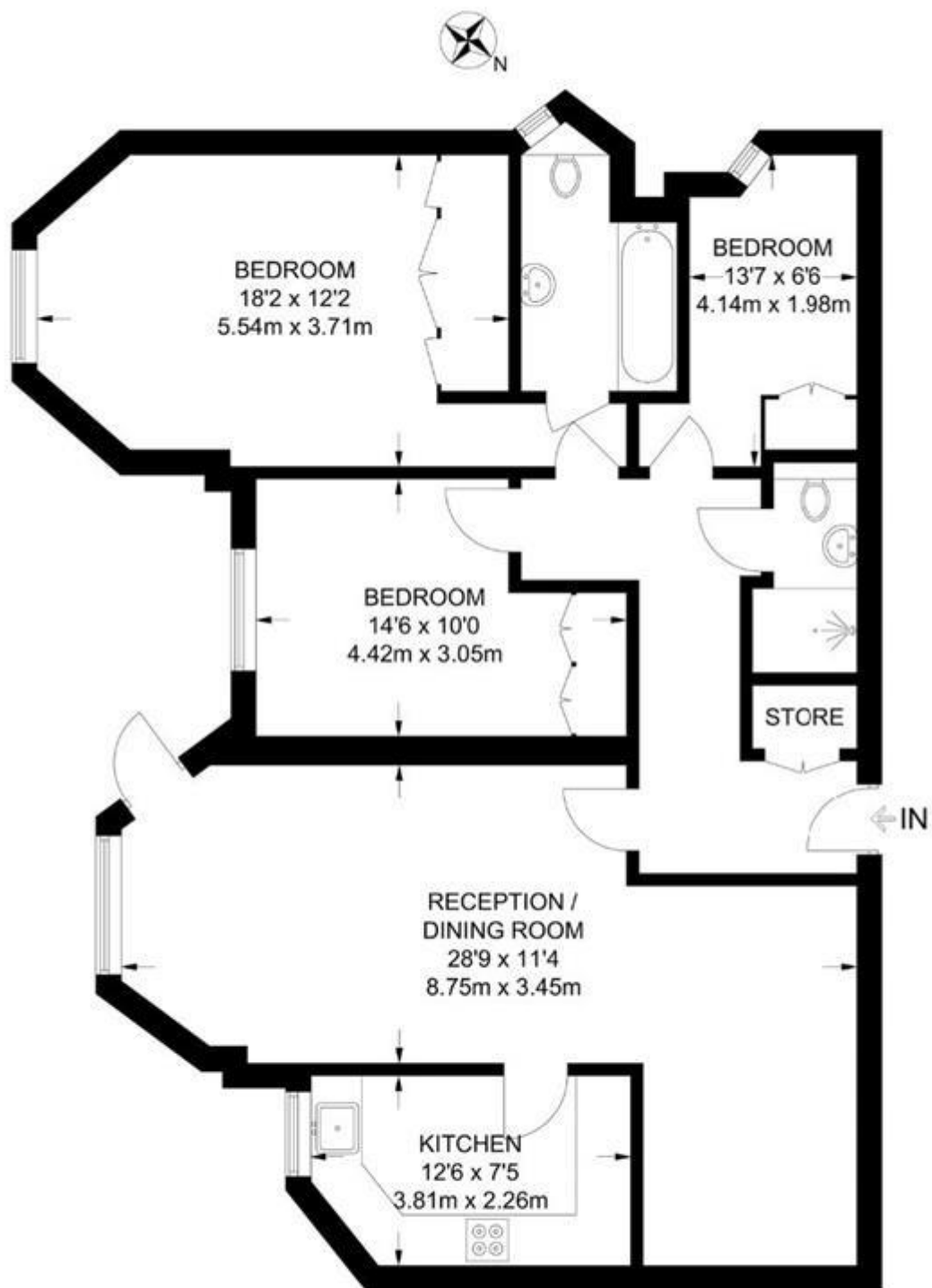

**APPROXIMATE GROSS INTERNAL AREA
1124 SQ FT / 104.4 SQ M**

This plan has been drawn for illustrative and identification purposes only.

Viewing by appointment only
 Maison Chase - Maison Chase
 41A Mill Lane, West Hampstead, London NW6 1NB
 Tel: 020 3951 7464
 Email: home@maisonchase.co.uk
 Website: www.maisonchase.co.uk

